

Southbow Landing Phase 2B

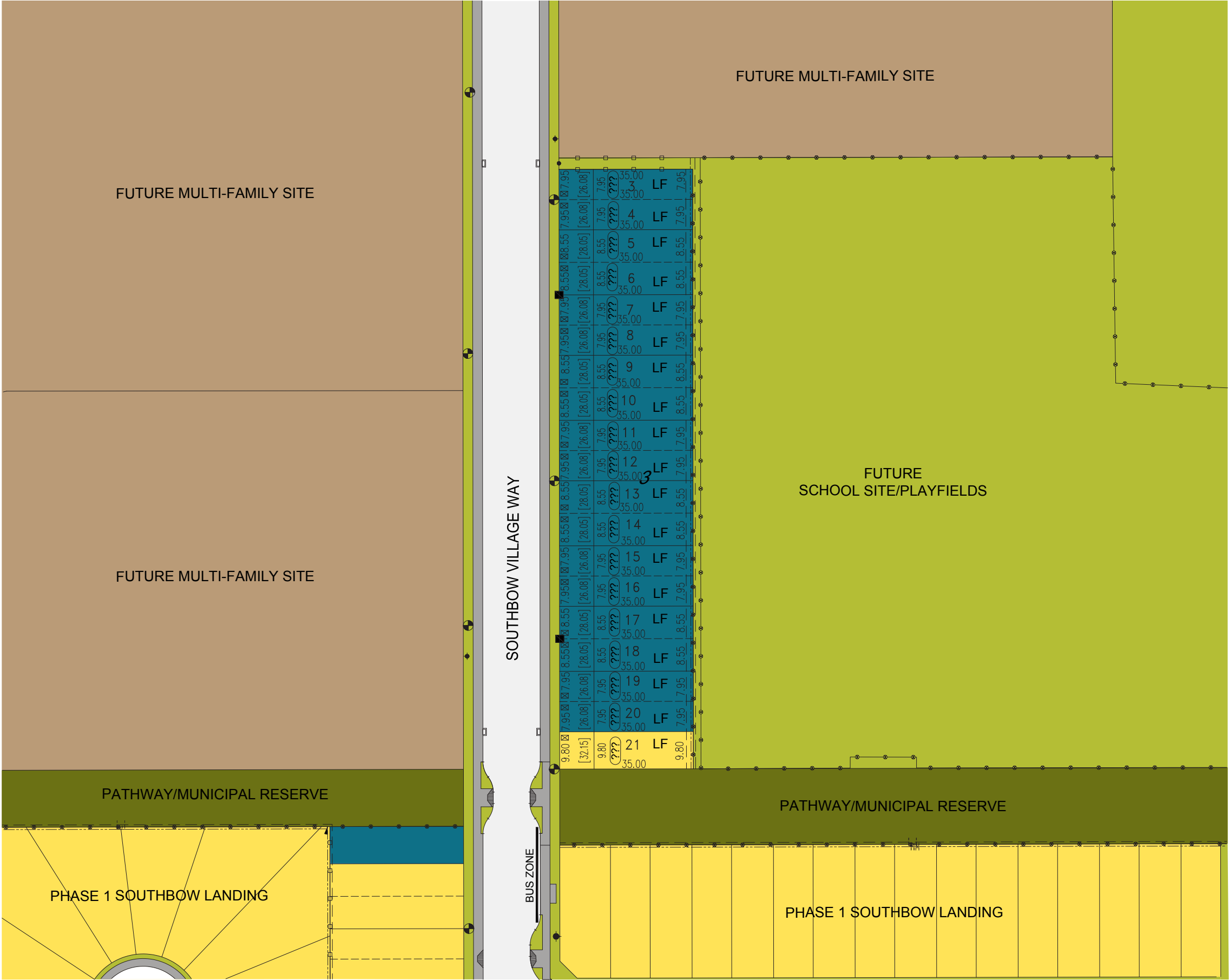

LEGEND

- LEGEND
- L - LEVEL LOT (Sideyard Drains To The Front)
 - BF - LEVEL LOT (Back To Front Drainage)
 - WF - FULL WALKOUT LOT
 - WB - BI-LEVEL STYLE WALKOUT LOT
 - LB - BI-LEVEL LOT
 - T - TRANSITION LOT
 - ⊠ - DRIVEWAY LOCATION
 - - ELECTRIC TRANSFORMER (PRELIMINARY)
 - ⊞ - ELECTRIC PULLBOX (PRELIMINARY)
 - - STREET LIGHTS (PRELIMINARY)
 - ⊕ - FUTURE STREET LIGHTS
 - - STREET LIGHT CABINET (PRELIMINARY)
 - △ - TELEPHONE PEDESTAL (PRELIMINARY)
 - ⊞ - TELEPHONE SERVICE VAULT (PRELIMINARY)
 - ⊞ - CABLE TV PEDESTAL (PRELIMINARY)
 - ⊞ - CABLE TV PULLBOX (PRELIMINARY)
 - ⊞ - CABLE TV PULLBOX w/ NEW MOUNTED PEDESTAL (PRELIMINARY)
 - ⊞ - CABLE TV POWER SUPPLY PEDESTAL (PRELIMINARY)
 - SC - THREE PHASE SWITCH CUBICLE (PRELIMINARY)
 - - HYDRANT
 - - CATCH BASIN
 - - CHAIN LINK FENCE
 - - WOOD SCREEN FENCE
 - ◆— - SOUND ATTENUATION FENCE
 - ①②③ - MUNICIPAL ADDRESS (PRELIMINARY)
 - ✉ - COMMUNITY MAILBOX
 - ≡≡≡ - CONCRETE DRAINAGE SWALE ROW
 - ≡≡≡ - UTILITY RIGHT OF WAY
 - - R-LD SINGLE FAMILY FRONT GARAGE
 - - R-MX SINGLE FAMILY FRONT GARAGE
 - - R-MX SINGLE FAMILY LANED
 - - R-MX DUPLEX FRONT GARAGE
 - - R-MX DUPLEX LANED

Notes:

Refer to legal plan of subdivision to confirm all lot dimensions.

Refer to utility rights of way and easement documents to determine restrictions on the extent of title.

NOT TO SCALE
November 2024